



Sunseeker 88 Yacht - 5102288
£ 7,041,894 Ex Tax



Boat Details

Make
Sunseeker**Model**
88 Yacht**Model Year**
2022**Location**
France**Max Speed***
28 knots

Engines

Details
2 x MTU M96X**Engine HP**
2000**Drive Type**
Shaft**Fuel Type**
Diesel

Dimensions

LOA
26.38m/86ft 7in**Draft**
6.47m/21ft 3in**Beam**
1.95m/6ft 5in**Weight**
75400kg/75.4t

Tankage

Fuel Capacity
11000l**Water Capacity**
1400l**Black Water Capacity**
400l

Accommodation

Cabins
4**Guests**
8 Berth(s)**Heads**
5**Crew Cabins**
2**Crew**
4 Berth(s)

*Performance details are intended as a guide only and are not binding and do not constitute part of any terms and conditions.



Description

The 88 Yacht has impressive, new to the brand, exterior lines and a sleek hardtop roof with an optional central opening canopy.

Powered by twin MTU 10V 2000s as standard, she accommodates eight guests and four crew in complete luxury and comfort reaching speeds of up to 28 knots.

The 88 Yacht features Sunseeker's industry-leading 'Beach Club' accessed by dual teak staircases featuring recessed LED lighting.

The 'Beach Club' transforms the area into a private outdoor sanctuary complete with an innovative X-TEND™ sunbed that converts to face aft at water level or when raised forward into the cockpit.

Set beneath is an overhead rain shower and plentiful stowage, including dedicated lockers for two SeaBobs.

The extended bathing platform is perfect for carrying a tender with an optional flybridge crane for a jet ski or similar.

Accommodation

The vast flybridge on the 88 Yacht enjoys a superb layout with beautifully appointed furniture on a spacious aft deck.

It's a brilliant space for entertaining with ample places to sit and relax thanks to companion seating adjacent to the helm and extended U-shaped seating.

Inside, there is a large forward galley that maximises an open-plan entertainment space.

Owners and crew can enjoy making use of ample practical storage space, as well as a dedicated fixed breakfast bar unit with two stools, creating an additional informal dining area.

The galley has a full-height premium fridge freezer and dishwasher as standard with space for wine coolers.

There is also the ability to fully close off the galley, allowing the crew to move around the yacht unnoticed with access from the lower helm on the starboard side that gives owners the chance to enjoy complete privacy.

The interior exudes luxury and has clever design cues throughout that make the yacht stand out, including diagonal stainless detailing on cabinetry and doors.

The layering of textural elements and the mix of furnishings and fabrics feels timeless with a modern twist.

Sunseeker has located the grand master stateroom central to the yacht, making the most of her substantial beam to maximise this private space.

The master stateroom, with its 55" TV as standard, enjoys a spacious dressing area with a double wardrobe and adjacent in the en suite featuring exquisite surfaces throughout are double sinks, an overhead rain shower, and plentiful stowage.



Platinum Package

Fin stabilization system providing stability underway and at rest.
Flybridge hardtop with retractable centre canopy and aft extending sun canopy.
Air Conditioning Tropical specification throughout the boat, with quieter running fans in lower cabins only
One 28kW 50Hz Generator and one 35kW 50Hz Generator.
Second shore power connection.
Hydraulic Stern thruster system.
Fuel polishing system.
Dimmable Lighting switching on all overhead lighting.
Two stainless steel drawer refrigerators with water cooled compressors in Flybridge wet bar.
Additional under counter Galley Refrigeration.
Teak Flybridge Decking.
Pair of Retractable Cleats for tender on platform.
Additional Stern spring cleats.
Carbon fibre companionway hatch at top of Flybridge stairs.
Sprung mattress for all cabin beds.

Entertainment Systems

1. Saloon Samsung 55" The Frame UHD 4K QLED Television with Apple TV App and Airplay 2 included with a Ultra HD Blu-ray player. Sonance upgraded front and rear speakers with Sonos Amps and Sonos Subwoofer. Dining area with two additional Sonance speakers with Sonos Amp.
2. Galley Samsung 43" UHD 4K Television with Apple TV App and Airplay 2 included. Sonance speakers with Sonos Amp.

3. Master Stateroom Samsung 55" The Frame UHD 4K QLED Television with Apple TV App and Airplay 2 included with a Ultra HD Blu-ray player. Sonance upgraded front and rear speakers with Sonos Amps.
4. Forward VIP cabin Samsung 55" UHD 4K Television with Apple TV App and Airplay 2 included. Sonance upgraded speakers with Sonos Amp.
5. Port Mid cabin Samsung 43" UHD 4K Television with Apple TV App and Airplay 2 included. Sonance upgraded speakers with Sonos Amp.
6. Starboard Mid cabin Samsung 32" HD Television with Apple TV, Sonance upgraded speakers with Sonos Amp.
- 7 Aft Cockpit zone audio with four 8" Sonance VPXT8R Extreme Speakers with Sonos Amp.
- 8 Flybridge deck zone audio with four 8" Sonance VPXT8R and two 6" VPXT6R Extreme Speakers with Sonos Amp.
- 9 Fore deck zone audio with two 6.5" Sonance VPXT6R Extreme Speakers with Sonos Amp. The zoning audio to be linked via the Sonos App with one tablet supplied for control of the zones

Main Console

Two Simrad MO24-T 24" Touchscreen Monitors with NSO evo3S Processor and OP50 keypad controller.
Additional 10" touchscreen controlling the Cm8 Sunseeker monitoring Simrad Halo 6 Pulse Compression Radar 6ft 72nm with velocity track.
Simrad GS25 GPS Antenna. Simrad Autopilot AP44 system. Simrad HS100 VHF with DSC. 2.4M whip VHF antenna.
Simrad depth Speed/Depth transducer with water temp B744V and Sonarhub modual.

Simrad structure scan 3D side scan transducers and Sonarhub 3D module.
Simrad Automatic Identification System NAIS500 Class B AIS Transponder system with dedicated 2.4M whip antenna and GPS receiver.
Simrad 110WX Ultrasonic Wind Sensor.
Richie Helmsman HF-743B Flush Mount Magnetic Compass

Flybridge Console

Two Simrad NSO evo3S 16" Touchscreen Multifunctional Displays and OP50 keypad controller.
Additional 7" touch-screen controlling the Cm8 Sunseeker monitoring.
Simrad Autopilot AP44 system.
Simrad second station RS90s VHF with DSC.
Richie Helmsman HF-743W Flush Mount Magnetic Compass

Other Extras

2 x Porta Romana - Neolith Wall Light (TWL 114) Stucco White fitted as standard
Additional MTU joystick manoeuvring system control on the aft docking station.
Only available with MTU joystick manoeuvring system above. Also not available with Aft docking engine control option
Aft cockpit covers package
Aft cockpit privacy screen - Electrically operated
Aft deck seating cushions with bespoke Coco Wolf loose furniture for the X-Tend option. Upholstery Fiji 7 with Ebonised legs. Bellecote Corner Chairs with 2 x Aquilla Small Coffee Tables. Table Tops - Italian Porcelain stoneware with Iroko wooden base surround. Top - Porcelain Statuario Supremo
All Guest Cabins to have electric Roman Blinds with Blackout linings

All Saloon Curtains and Blinds throughout Saloon and Dining to be Electric
Atlas Autosshore 30KVA Shore Supply Voltage Regulator. Ensures galvanic isolation from shore supply, stabilises the onboard voltage from variations in shore supply voltage. Allows connection to 400V supplies. upgrades to 125A Auto Troll for Transmissions for slow speed manoeuvring
Carbon fibre and chrome overhead shower stand with socket on the stern platform
Carpet upgrade throughout Guest Cabins and stairwell to Elements Cosmopolitan
Carpet Upgrade to Saloon Elements - Mai Tai in lieu of standard as per 503/88
CCTV with 5 Cameras: 2 x Port and starboard docking cameras. 2 x Infra red located in the engine room plus 1 x camera located on the flybridge overhang facing aft. Image to be displayed on Nav screens at the helm
Cellular signal booster antenna. SES install, SIB to run cables
Class XII safety kit for vessel based on 8 person. Safety kit can be modified to suit use and location of vessel (price may vary).
Compass Swinging and adjustment with correction card
Crew mess 24" HD Television. In the crew mess and each of the cabins a Fusion 770 Apollo head unit for AM/FM radio, USB input, Bluetooth and Apple Airplay connectivity to users device with two Fusion ceiling speakers
Dining Ceiling lamp to have Chrome metal work with shades in Crepe Satin Silver - 44 with lining in Silver
Dining flooring to have carpet insert in Elements - Wall Street - Mai Tai. See GA Dining Table to be rectangular in shape with a small stone insert in Vanilla Noir with stainless steel surround, quartered directional grain top in Smoked Eucalyptus and stainless steel nosing detail.

Additional

Dometic Safe MD 281 concealed in cabinetry (8.3 lts. W280mm x H165mm x D235mm) for the Forward VIP Cabin

Dometic Safe MD 281 concealed in cabinetry (8.3 lts. W280mm x H165mm x D235mm) for the Master Stateroom

Flybridge Covers Package - Flybridge seating, sunpad, table and helm seat covers

Flybridge Wetbar mouldings and doors spray paint finished

Fore Deck Covers Package - Foredeck seating, sunpad and table covers

Fore deck cushions with optional folding sunbed

Freshwater pressure washing of chain with directed outlet

Full sea and system commissioning

Galley to have additional storage locker in lieu of TV on Aft Galley bulkhead above breakfast bar. Storage to run to the same height as the breakfast bar and to be finished in Nickel Grey Lacquer 91005 Satin. No TV required

Grey water from showers and wash basins will drain directly to sump boxes and upgraded 850 litre grey water tank. Grey water from galley services will drain either directly overboard or to grey water tank. Sump boxes pump into the grey water tank. Discharge from the grey water tank via 1 x Sealand Pump 24Vdc pumping directly over board or via a shore side suction facility through a deck fitting when available

Hydraulically lifting platform with maximum lift capacity of 1000 kg with Tender maximum weight of 900 kg

Interior Fabric upgrades

Interior Wood Finish - Smoked eucalyptus figured high sheen satin finish

Main deck day head in lieu of standard cloakroom

Main Deck Saloon sliding door on the starboard side

Marco portable electric transfer pump Oil change system for engines gearboxes and generators with quick coupling connection pipes

Movement of Yacht to Port of Shipment for export including necessary paperwork

MTU-Xenta joystick manoeuvring system with dual station control

Octo Marine Compact Water Softener required for the domestic fresh water system. Fitted in-line from the vessels fresh water shore supply. The outlet will be fitted with valves to fill either direct to tank or to the main system

Parasol with offset post with two sockets. One either side of the Fore deck

Port guest cabin to be configured with single berths to slide together to create a double berth. Ensure that bed coverings are ordered for both double and single set up

Porta Romana Cologne Table Lamp in Charcoal GLB49 Pt 644072 located Forward on Port Storage unit

Porta Romana Holden Desk Lamp SLB70 located on the Aft end of Starboard Vanity desk as standard

Saloon Outer Headlining panels to be finished in Super White Lacquer 9016 in lieu of Lining

Separate Miele washing machine and Miele tumble dryer in the Crew Mess.

Spradling Hitch or Sunbrella premium exterior upholstery upgrade

Standby fresh water pump Gianneschi Ecoinox 2CE 24Vdc self-priming pump, pressure controlled. Standby pump fitted to enable both pumps to run at the same time if required

Storage Cage located in the Engine Room

Sunseeker Cm8 integrated power management 10" Glass touch display, boat monitoring and full access control repeater in the crew mess

Additional

Three Besenconi polished stainless steel bar stools
Trailing Pumps. Used to supply oil pressure for gearbox lubrication during wind-milling situations, this may include running on one engine or when under tow.
When running on one engine at 10 knots 2800 NM can be achieved (only possible if confirmed at stage of contract and 16 weeks prior to mould)
Twin Lewmar V8 24 Volt DC Windlass. Vertical Gypsy and Capstan drum. Manual hand wheel brake and Devils Claw chain stopper. One Lewmar 80kg galvanised Delta anchor and One Lewmar 50kg galvanised Delta anchor. 1 x 100 meters and 1 x 60 meters of 12mm high tensile galvanised short link chain with anchor swivel
Underwater lights. Lumishore TIX403 LED x 8 - Dual colour white / Blue. Four across the stern and two either side
Upgrade to Flybridge hardtop to include the tilting vane system in lieu of the soft retractile central canopy
Upgraded hard surfaces to Dining storage units both Port and Starboard in lieu of standard
Upholstered Fwd bulkhead panel above the stbd low level unit to run up to the Stbd Smoked Eucalyptus Column. No individual lacquer panel required.
Vanity to stool to be BR Marine Cross over upholstered in Taupe Leather with dark wood legs.
Water Maker Idromar 250 litres per hour (MC5S-250)
Wetbar raised shelf bar top with LED lights
Wood flooring in dining
Wood flooring in the VIP lobby from aft door, steps and up to VIP Stateroom and en-suite entrance.
Wood flooring on the starboard side of the Master Stateroom in front of vanity

and into the wardrobe space. Rest of cabin around the bed perimeter and port side to be carpeted.

X-Tend. Sun-lounger Transforma - The platform locker door folds out electrically exposing a large sun-lounger. Alternatively the door can fold up forming an aft deck sun-lounger thus extending the cockpit space with the stern glazed safety rails bi-folding to the side

[Click Here to view 360 Virtual Tour](#)



1 - Exterior













7 - Side Deck







10 - Flybridge









13 - Aft Cockpit



14 - Aft Cockpit









18 - Dining







21 - Galley





23 - Master Cabin





27 - VIP Cabin



28 - VIP Cabin



31 - Twin Guest Cabin





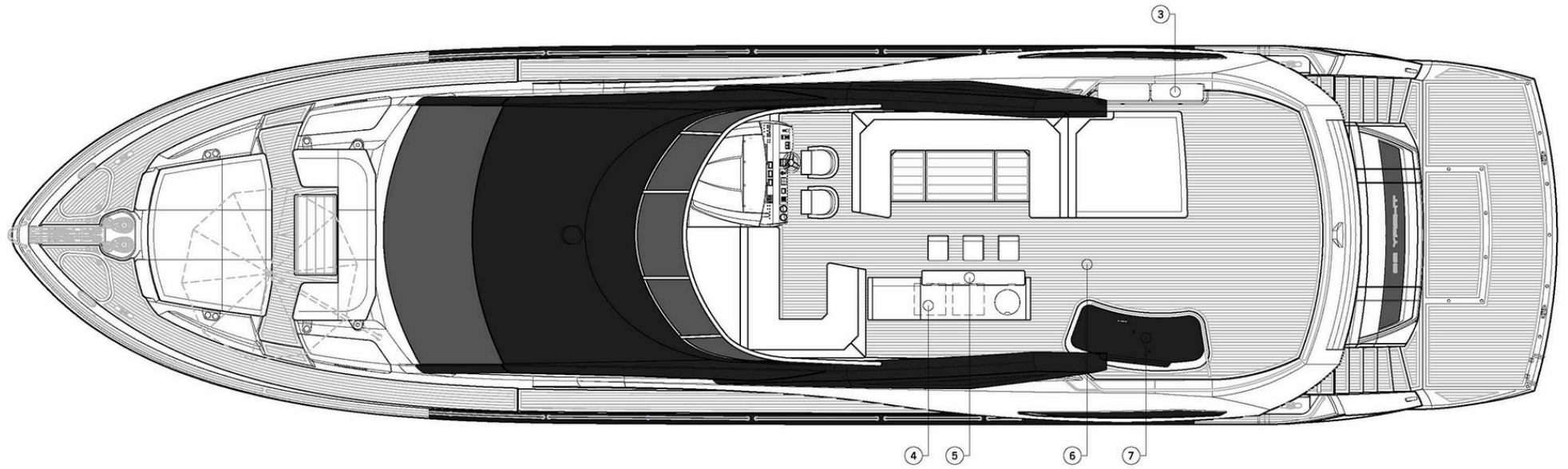

Layout - Main Deck

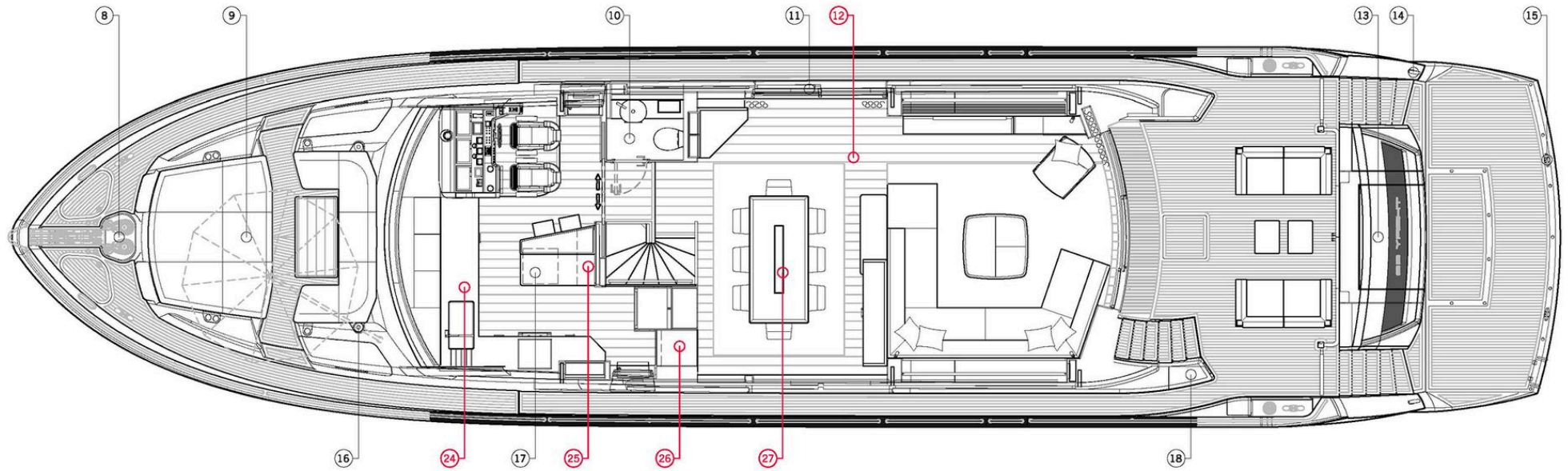

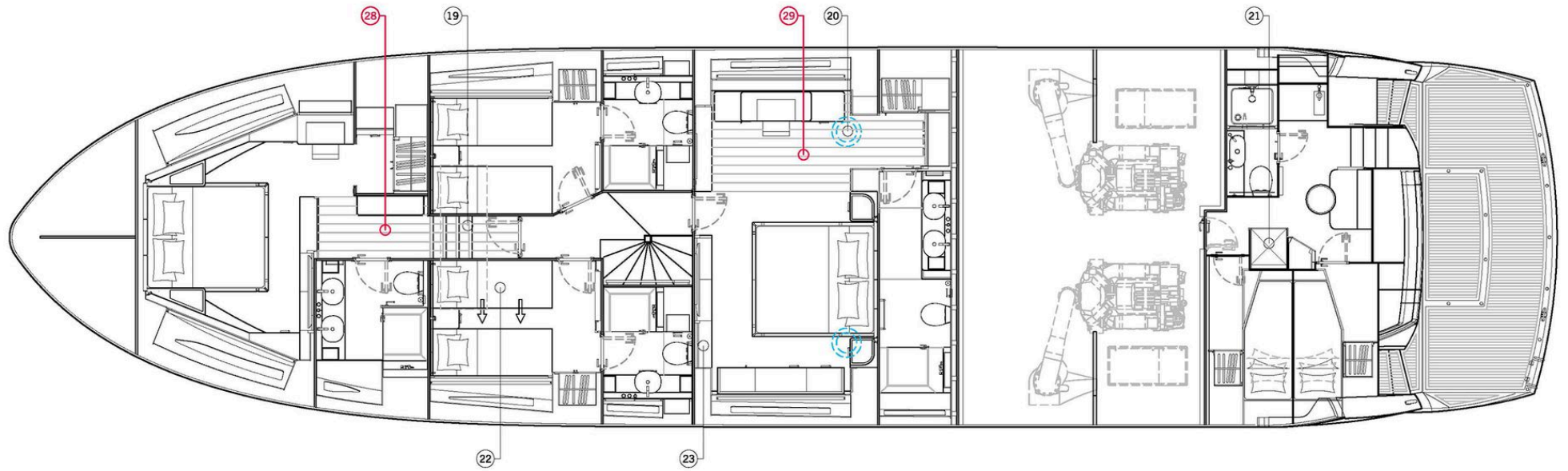



Your Dedicated Broker

After graduating with BA Hons degree in Maritime and Business Law in 2001, Richard headed to Mallorca to enjoy a summer job with Sunseeker. After a successful summer season with Richard already familiar with boating from a young age and holding a Yachtmaster qualification, he was offered an opportunity in London on a permanent basis to head up the warranty/after-sales department.

Richard developed further client contact through warranty and after sales requests together with the handover/tuition of boats to clients. In 2008 Richard seized the opportunity to head up Sunseeker Greece managing the Greek territories and increasing sales in this area. Gaining experience in managing Sunseeker Greece, 2012 saw Richard acquire the role of Sales Director for Sunseeker Spain enabling him to develop the entire sales network and to further continue his passion for boating in Mallorca and Spain.

Richard Tilley

richard@sunseekerlondon.com
(+44) 7785 347116



Sunseeker London, 34-36 Davies Street, Mayfair, W1K 4NF

Tel: +44 (0) 207 355 0980

Web: www.sunseekerlondon.com

Sunseeker London Group presents the information and the details of this Vessel in good faith and does not expressly or impliedly guarantee or warrant the accuracy of this information nor expressly or impliedly warrant the condition of the Vessel. All information and details are intended as a guide only and are not binding and do not constitute part of any terms and conditions. A prospective purchasers should instruct his agents, or his surveyors, to investigate such details in order to validate all information. All prospective purchasers should be aware that the "Manufacturers Model Year" varies from builder to builder and does not necessarily correspond to the Vessel's year of build. This Vessel is offered subject to prior sale, price change, or withdrawal without notice. It is noted that this information may be displayed in various languages; however, the interpretation of the language that shall take precedence shall always be UK English.